



Screwdriving Technology

Automation

Air Motors

Air Tools



## Straight Grinders

Vane Motor / Turbine Drive

Power Output: 1,2 - 2,8 kW (1.6 -3.8 HP)

- optimum power-to-weight ratio
- robust
- highly durable
- simple operation
- ergonomic

### Turbine Grinders:

- Double the Power!  
Half the Weight!
- oil-free and maintenance-free operation, turbine motor does not require airline lubrication
- high material removal
- low air consumption

Our air straight grinders are used with flat/cutting-off/tapered grinding disks, wherever heavy-duty fabrication is required on steel and castings or when deburring welding-, casting-, and ridge-seams. It has never been easier to perform smooth or coarse grinding of steel & cast iron in foundries, or when polishing welding seams or when fabricating casted parts.

Our straight grinders can also be used with steel brushes for the removal of rust or when descaling rolled steel and forgings.



## THE BEST TOOLS FOR EFFICIENT MATERIAL REMOVAL

### Optimum power-to-weight ratio

Straight grinders are characterized with keeping the speed of the tool constant, even if tool is operated at maximum. Motor construction uses modern materials and production technology to achieve power maximum of 2,8 kW. Power output of the Turbine Grinder: The already high power-to-weight ratio of our standard air-grinders is surpassed by our grinders equipped with turbine motors.

### Robust

Our robust straight grinders are designed for the using in heavy-duty fabrication (foundries, quarries, buildings, engineering).

### Highly durable

The robust design of the straight grinders assures a long life span - even when the tool is under continued operation.

### Simple operation

Our Grinders are reliable and assure a simple operation and ease of maintenance. The straight grinders operate at an extreme low noise-level. The ergonomic design of the tool-grip reduces the machine's vibration.

### Oil-free operation

For an oil-free operation, we offer our special line of turbine grinders.



## TYPE KEY

### GS T 815 - 220 B X A E O

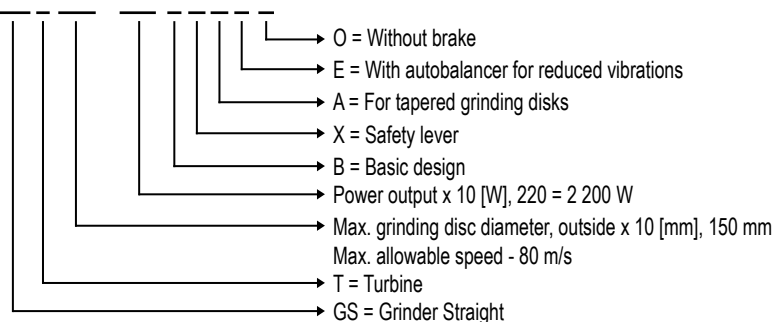

# SPECIFICATIONS - STRAIGHT GRINDERS WITH TURBINE DRIVE

## Straight grinders with turbine drive

- for the fabrications on steel, for the deburring of welding-, casting-, and ridge-seams (with grinding disks)
- for the removal of rust, the descaling of rolled steel and forgings (with steel brushes)

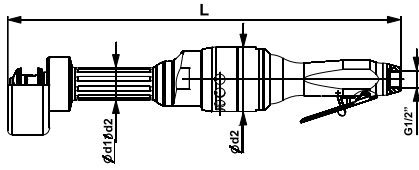

GST 810-220BXO

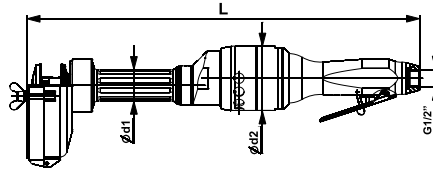

GST 815-220BXO

### Advantages:

- oil-free and maintenance-free operation, turbine motor does not require airline lubrication
- Double the Power! Half the Weight!
- high material removal
- low air consumption

For flat grinding disks	Model Part No.	GST 810-220BXO 310109C		GST 815-220BXO 310089C	
Speed (no load)	min <sup>-1</sup> (rpm)	14 500		10 000	
Max. power output	kW (hp)	2,2 (2.95)		2,2 (2.95)	
Air consumption (loaded)	m <sup>3</sup> /min (cfm)	2,1 (74.15)		2,1 (74.15)	
Air consumption (no load)	m <sup>3</sup> /min (cfm)	0,65 (22.95)		0,65 (22.95)	
I.D. of air inlet hose	mm (in)	13 (.51)		13 (.51)	
Flat grinding disk-Ø outside	mm (in)	100 (4") (4")		150 (6") (6")	
Flat grinding disk-Ø inside	mm (in)	20 (.79)		20 (.79)	
Flat grinding disk - width	mm (in)	20 (.79)		20+25 (.79+.98)	
Max. allowable speed	m/s (ft/s)	80 (262.4)		80 (262.4)	
Grinder-Ø d1/d2	mm (in)	38/78 (1.5/3.07)		38/78 (1.5/3.07)	
Grinder length L	mm (in)	476 (18.74)		476 (18.74)	
Air connection		thread 1/2" female		thread 1/2" female	
Weight	kg (lbs)	3 (6.60)		3,6 (7.94)	

Specifications at 90 psi (6,3 bar)

Standard Equipment:	Part Number
Allen key 6 mm	800449
T-wrench	805080

Optional Accessories:	Part Number
Swivel connector, G1/2"	6078628
Hose set (hose LW 13 mm, length 4 m)	315130A

## WE RECOMMEND:

**Tyrolit-Grinding Disks - for grinding of steel and cast iron (grey, form-able)**

Minimum order quantity: 50 pcs.



Tyrolit-Grinding Disks - dimensions, quality, applications	Part Number
1F80 100x20x20 mm, A30S-BFX 80, steel	6078693
1F80 100x20x20 mm, 112A24Q4BF88 80, cast iron, form-able	6078844
1F80 100x20x20 mm, 805A24Q4BF88 80, cast iron, grey	6078845
1F80 100x25x20 mm, A30S-BFX 80, steel	6078846
1F80 100x25x20 mm, 112A24Q4BF88 80, cast iron, form-able	6078847
1F80 100x25x20 mm, 805A24Q4BF88 80, cast iron, grey	6078848
1F80 150x20x20 mm, A30S-BFX 80, steel	6078694
1F80 150x20x20 mm, 112A24Q4BF88 80, cast iron, form-able	6078849
1F80 150x20x20 mm, 805A24Q4BF88 80, cast iron, grey	6078850
1F80 150x25x20 mm, A30S-BFX 80, steel	6078851
1F80 150x25x20 mm, 112A24Q4BF88 80, cast iron, form-able	6078852
1F80 150x25x20 mm, 805A24Q4BF88 80, cast iron, grey	6078853

On special request we can offer customized grinding disks to fit your exact applications.

### Optional Accessories:

**Swivel connector G1/2"**  
Part No. 6078628

The swivel is an ingenious multi-directional connector. Connect your tool and the hose will stay in ideal position however much you and the tool move around. It takes the effort out of working in those cramped spaces. The hose feels almost weightless and it reduces hose wear.



**Set - hose 4 m, connection**  
Part No. 315130A



## SPECIFICATIONS - STRAIGHT GRINDERS WITH VANE MOTORS

### Straight grinders with vane motor

- for the fabrications on steel, for the deburring of welding-, casting-, and ridge-seams (with grinding disks)

- for the removal of rust, the descaling of rolled steel and forgings (with steel brushes)

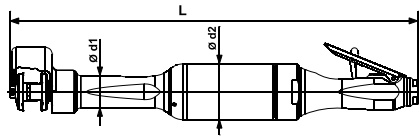

GS 508-120BXA

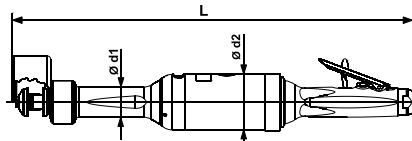

GS 510-230BX

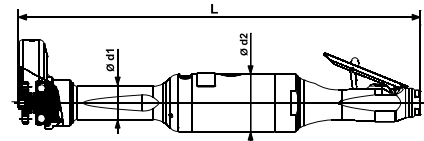

GS 812-150BXE

For flat grinding disks	Model Part No.	GS 508-120BX 6061228A	GS 510-230BX 6061289A	-
For cutting-off disks, with autobalancer*	Model Part No.	-	-	GS 812-150BXE* 6061279A
For tapered grinding disks	Model Part No.	GS 508-120BXA 6061228B	-	-
Speed (no load)	min <sup>-1</sup> (rpm)	12 000	9 500	12 000
Max. power output	kW (hp)	1,2 (1.61)	2,3 (3.08)	1,5 (2.0)
Air consumption (loaded)	m <sup>3</sup> /min (cfm)	1,2 (42.37)	2,2 (77.68)	1,7 (60.0)
Air consumption (no load)	m <sup>3</sup> /min (cfm)	0,65 (22.96)	0,7 (24.72)	0,7 (24.7)
I.D. of air inlet hose	mm (in)	13 (.51)	16 (.63)	13 (.51)
Grinding disk-Ø outside	mm (in)	80 (3")	100 (4")	125 (5")
Grinding disk-Ø inside	mm (in)	20 (.79)	20 (.79)	22,23 (.84)
Grinding disk - clamping range	mm (in)	20÷25 (.79÷.98)	20÷25 (.79÷.98)	2,5÷8 (.10÷.31)
Max. allowable speed	m/s (ft/s)	50 (164)	50 (164)	80 (262.5)
Grinder-Ø d1/d2	mm (in)	36/62 (1.42/2.44)	39/72 (1.54/2.83)	36/62 (1.42/2.44)
Grinder length L	mm (in)	453 (17.83)	520 (20.47)	436 (17.17)
Air connection		thread 3/8" female	thread 1/2"female	thread 3/8"female
Weight	kg (lbs)	2,6 (5.73)	4,0 (8.82)	2,7 (5.95)

Specifications at 90 psi (6,3 bar)

\* With Autobalancer for reduced vibrations

Standard Equipment:	Part Number		
Allen key 2 mm	800443	800443	800443
Allen key 5 mm	800448	-	800448
Allen key 6 mm	800449	800449	800449
Hose nozzle G3/8"			
Hose nozzle G1/2"-13 mm	6013772	6013772	6013772
T wrench	-	-	828832

Optional Accessories:	Part Number		
Plug 27SF AK17 SXN	6074950	-	-
Plug 27SF AK21 SXN	6072227	6072227	6072227
Hose nozzle, turn-able G1/2"	-	6021377	-
Hose nozzle, turn-able G3/8"	6022433A	-	6022433A
O ring	6070103	-	6070103
Swivel connector G3/8"	816376	-	816376
Swivel connector G1/2"	-	6078628	-
Hose set (hose LW 13 mm, length 4 m)	-	315130A	-

#### Optional Accessories:

**Swivel connector G1/2"**  
Part No. 6078628

The swivel is an ingenious multi-directional connector. Connect your tool and the hose will stay in ideal position however much you and the tool move around. It takes the effort out of working in those cramped spaces. The hose feels almost weightless and it reduces hose wear.



**Set - hose 4 m, connection**  
Part No. 315130A



## SPECIFICATIONS - STRAIGHT GRINDERS WITH VANE MOTORS

### Straight grinders with vane motor

- for the fabrications on steel, for the deburring of welding-, casting-, and ridge-seams (with grinding disks)

- for the removal of rust, the descaling of rolled steel and forgings (with steel brushes)

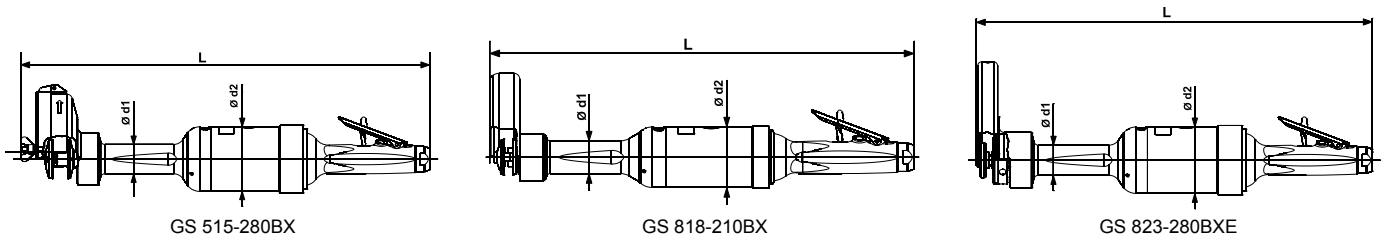

For flat grinding disks	Model Part No.	GS 315-240BX 6061141A	GS 515-280BX 6061301A	-	-
For cutting-off disks	Model Part No.	-	-	GS 818-210BX 6061296A	-
For cutting-off disks, with Autobalancer*	Model Part No.	-	-	GS 818-210BXE* 6061296B	GS 823-280BXE* 6061307B
Speed (no load)	min <sup>-1</sup> (rpm)	4 000	6 400	8 500	6 600
Max. power output	kW (hp)	2,4 (3.22)	2,8 (3.75)	2,1 (2.81)	2,8 (3.75)
Air consumption (loaded)	m <sup>3</sup> /min (cfm)	1,9 (67.09)	2,4 (84.75)	2,1 (74.2)	2,4 (84.75)
Air consumption (no load)	m <sup>3</sup> /min (cfm)	0,7 (24.72)	0,8 (28.25)	0,65 (23.0)	0,8 (28.25)
I.D. of air inlet hose	mm (in)	16 (.63)	16 (.63)	16 (.63)	16 (.63)
Grinding disk-Ø outside	mm (in)	150 (6")	150 (6")	180 (7")	230 (9")
Grinding disk-Ø inside	mm (in)	20 (.79)	20 (.79)	22,23 (.84)	22,23 (.84)
Grinding disk - clamping range	mm (in)	20÷25 (.79÷.98)	20÷25 (.79÷.98)	8÷10 (.31÷.39)	2,5÷10 (.1÷.39)
Max. allowable speed	m/s (ft/s)	32 (105)	50 (164)	80 (262.5)	80 (262.5)
Grinder-Ø d1/d2	mm (in)	39/86 (1.54/3.39)	39/86 (1.54/3.39)	39/72 (1.54/2.83)	39/86 (1.54/3.39)
Grinder length L	mm (in)	564 (22.20)	545 (21.46)	506 (19.92) 511 (20.12)	513 (20.20)
Air connection		thread 1/2" female	thread 1/2" female	thread 1/2" female	thread 1/2" female
Weight	kg (lbs)	6,5 (14.33)	5,4 (11.90)	4,0 (8.82) 4,25 (9.37)	5,5 (12.13)

Specifications at 90 psi (6,3 bar)

\* With Autobalancer for reduced vibrations

Standard Equipment:	Part Number			
Allen key 2 mm	-	800443	800443	800443
Allen key 4 mm (for design E, with autobalancer)	-	-	800447	800447
Allen key 6 mm	800449	800449	800449	800449
Hose nozzle G1/2"	6013767	6013767	6013767	6013767
O ring	802517	802517	802517	802517
T wrench (for design E, with autobalancer)	-	-	828832	828832

Optional Accessories:	Part Number			
Swivel connector G1/2"	6078628	6078628	6078628	6078628
Nipple	6072227	6072227	6072227	6072227
Hose nozzle G1/2"	6021377	6021377	6021377	6021377
Hose set (hose LW 13 mm, length 4 m)	315130A	315130A	315130A	315130A

#### Optional Accessories:

**Swivel connector G1/2"**  
Part No. 6078628

The swivel is an ingenious multi-directional connector. Connect your tool and the hose will stay in ideal position however much you and the tool move around. It takes the effort out of working in those cramped spaces. The hose feels almost weightless and it reduces hose wear.



**Set - hose 4 m, connection**  
Part No. 315130A



**DEPRAG**  
DEPRAG CZ a.s., Lázně Bělohrad



DEPRAG CZ a.s., T. G. Masaryka 113, 507 81 Lázně Bělohrad - Czech Republic  
Tel.: +420-493 771 511, Fax: +420-493 771 623, E-mail: [sales@deprag.cz](mailto:sales@deprag.cz), Internet: [www.deprag.cz](http://www.deprag.cz)

Specifications subject to change without prior notice